



# Cable Laying Products

**Edition 12**



# Contents

Page

Tigerod Rodding Equipment

2



Drum Handling Equipment

5



Cable Laying Accessories

6



Cable Lubricant

7

Underground Cable Equipment

8



Screw-On Hauling Eyes

11



Conduit & Manhole Cable Guides

12



Mandrels & Swivels

14



Aerial Equipment

16



Quick Flick Shelters

18



Wire Cable Grips

19



Cable Winching & Jetting Equipment

20



# RODDING EQUIPMENT

## Continuous Fibreglass Duct Rod - Tigerrod

TIGEROD is CLP's range of continuous fibreglass duct rod. Diameters 6 and 8mm have a 1mm and diameters 3 and 4mm have a 0.5mm copper wire trace and detachable pulling eye as standard.

It is made from pultruded fibreglass strands jacketed with a 2mm tough polypropylene coating to give a unique combination of strength and durability.

- Dispenser units have a hand operated brake for safety and ease of use.
- TDWK-68 4 wheel kits are available for TDUS-6 and TDUS-8 dispensers.



Dispenser	Fibreglas Core Dia	OD	Conduit Size mm	Length									
				50m	60m	80m	100m	125m	150m	200m	250m	300m	
				(Add below number to complete TDUS code - eg.TDUS-3060)									
TDUS-3	3mm	5mm	up to 50		3060	3080	3100						
TDUS-4	4mm	6mm	50 - 80	4050	4060	4080	4100	4125	4150				
TDUS-6	6mm	8mm	80 - 100			6080	6100	6125	6150	6200			
TDUS-8	8mm	10mm	100 - 150				8100	8125	8150	8200	8250	8300	

Refill Rolls to suit above dispensers

- Refill rolls of rod are available in standard lengths as shown in the table.
- Please order refills with the part number TRF as the prefix.

Code example: Refill roll to suit TDUS-3060 dispenser is TRF-3060.

*Non standard lengths up to the maximum shown for each rod diameter can be quoted on request.*

## Hand Held Mini Rodder (Donut Rodder)

Economic, hand held, lightweight and robust mini rodder for small projects. 3mm x 25 metre (conductive trace)

### Code

MRH-03



## Hand Rods PVC and Fibreglass

All hand rods are fitted with a male and female threaded coupling on each end, suitable for use with CLP rodding accessories.



Material	Rod Size	3mm	4mm	6mm	8mm	22mm
(Please quote CLP code number shown below)						
Fibreglass	1.5 m	THR-0315	THR-0415	THR-0615	THR-0815	•
Fibreglass	2.0 m	•	•	THR-0620	THR-0820	•
Fibreglass	3.0 m	•	•	•	THR-0830	•
PVC	3.0 m	•	•	•	•	THR-223M

## Nylon Coils

15mm x 4m. Non conductive, very flexible excellent for small cavity work.

### Code

PFRGLS-4

### Description

4 metre roll



# RODDING EQUIPMENT

## Roller Guide

The multi-directional twist of the roller guide stops the rod from getting jammed under the cable.

<u>Code</u>	<u>Description</u>
TRG-22	Roller Guide 22 to suit 22mm PVC rod
TRG-68	Roller Guide 68 to suit 6mm & 8mm rod



## Flexible Leader

Screwed onto the end of the rod to assist through tight bends.

<u>Code</u>	<u>Description</u>
TFL-04	Fibreglass to suit 4mm rod
TFL-68	Fibreglass to suit 6mm & 8mm rod
TFL-22	Fibreglass to suit 22mm PVC rod
SFL-03	Metal Spring to suit 3mm rod
SFL-04	Metal Spring to suit 4mm rod
SFL-68	Metal Spring to suit 6mm & 8mm rod



## Couplings

Using 2 part epoxy resin, glued onto ends of continuous fibreglass.

<u>Code</u>	<u>Description</u>
<u>Male</u>	<u>Female</u>
TMC-03	TFC-03 to suit 3mm rod
TMC-04	TFC-04 to suit 4mm rod
TMC-06	TFC-06 to suit 6mm rod
TMC-08	TFC-08 to suit 8mm rod



## Removable Pulling Eyes

<u>Code</u>	<u>Description</u>
TRE-03	Pulling Eye to suit 3mm rod
TRE-04	Pulling Eye to suit 4mm rod
TRE-68	Pulling Eye to suit 6mm & 8mm rod
TREB-68	Bullet Pulling Eye to suit 6mm & 8mm rod
TREB-22	Bullet Pulling Eye to suit 22mm PVC rod



## Removable Tapered Knob

<u>Code</u>	<u>Description</u>
TRK-03	Tapered Knob to suit 3mm rod
TRK-04	Tapered Knob to suit 4mm rod
TRK-68	Tapered Knob to suit 6mm & 8mm rod



## Joining Kit

Consists of 3 joiners, 2 part epoxy resin, mixing stick and emery paper.  
NOTE: Joiners can be sold separately.

<u>Code</u>	<u>Description</u>	<u>Code</u>	<u>Description</u>
TJK-03	Joining Kit to suit 3mm (TDUS-3)	TJ-03	Joiner only for 3mm rod
TJK-04	Joining Kit to suit 4mm (TDUS-4)	TJ-04	Joiner only for 4mm rod
TJK-06	Joining Kit to suit 6mm (TDUS-6)	TJ-06	Joiner only for 6mm rod
TJK-08	Joining Kit to suit 8mm (TDUS-8)	TJ-08	Joiner only for 8mm rod



# RODDING EQUIPMENT

## Universal Kit

Consists of 2 male couplings, 2 joiners and 2 removable eyes  
(See below for kit components and relevant codes), 2 part epoxy resin, mixing stick and emery.

<u>Code</u>	<u>Description</u>
UJK-03	Kit comprises: 2 x TMC-03, 2 x TJ-03, 2 x TRE-03
UJK-04	Kit comprises: 2 x TMC-04, 2 x TJ-04, 2 x TRE-04
UJK-06	Kit comprises: 2 x TMC-06, 2 x TJ-06, 2 x TREB-68
UJK-08	Kit comprises: 2 x TMC-08, 2 x TJ-08, 2 x TREB-68



## Swivel Couplings

Used to join two lengths of rod together.

<u>Code</u>	<u>Description</u>
TSC-68FF	Swivel Coupling FF - For 6 and 8mm rod
TSC-68MF	Swivel Coupling MF - For 6 and 8mm rod



## Mini Harness

For pulling back more than one cable at a time.

<u>Code</u>	<u>Description</u>
TMH-22	Mini Harness for 22mm PVC rod
TMH-68	Mini Harness for 6mm and 8mm rod



## Sand Scoop

For removing debris from conduit.

<u>Code</u>	<u>Description</u>
TSS-0845	Suits 8mm rod, 45mm dia.
TSS-0890	Suits 8mm rod, 90mm dia.
TSS-2290	Suits 22mm rod, 90mm dia.



## Hook 'n' Loop

By entering from opposite ends, the Hook 'n' Loop set makes coupling of two rod lengths easy.

<u>Code</u>	<u>Description</u>
THL-0890	Suits 6 & 8mm rod & 90mm dia.
THL-2290	Suits 22mm rod & 90mm dia.



## Crank Handle

Connects on to end of 22mm hand rods to assist twisting the rods in a clockwise direction.

<u>Code</u>	<u>Description</u>
TCH-22MF	Crank Handle



# DRUM HANDLING EQUIPMENT

## Hydraulic Drum Jacks

2 sizes of manually operated jack stands allow for the differing sizes of drums up to a flange diameter of 3 metres and a width of 1.2 metres.

The hydraulic drum jack conveniently folds down for storage and transport.

<u>Code</u>	<u>Max Dia Flange</u>	<u>Max Weight</u>	<u>Drum Width*</u>
HDJ-1500	2 metres	3 tonnes	Up to 800mm
HDJ-4000	3 metres	8 tonnes	Up to 1200mm

\*Longer bar lengths

<u>Model</u>	<u>In Use (mm)*</u>	<u>Folded (mm)**</u>
HDJ-1500	700 x 1110 x 865	700 x 250 x 865
HDJ-4000	940 x 1635 x 1240	940 x 280 x 1240

\*\*Measurements are for each stand only  
(2 stands per set)



## Drum Trolley

Suitable for cable drums with a flange diameter up to 1400mm and a width of 700mm. Maximum safe load 220kg.

The Drum Trolley can be collapsed for easy storage and transport.

<u>Code</u>	<u>Description</u>
HDT-0901	Drum Trolley with foot brake



## Drum Caddy

<u>Code</u>	<u>Description</u>
CDC-350	For electrical cable reels
CDC-800	Fold-up drum stand (Approx size 900 x 42 x 60mm Height from ground to axle 260mm)
CDC-500	Fold-up cable reel stand for 6 drums

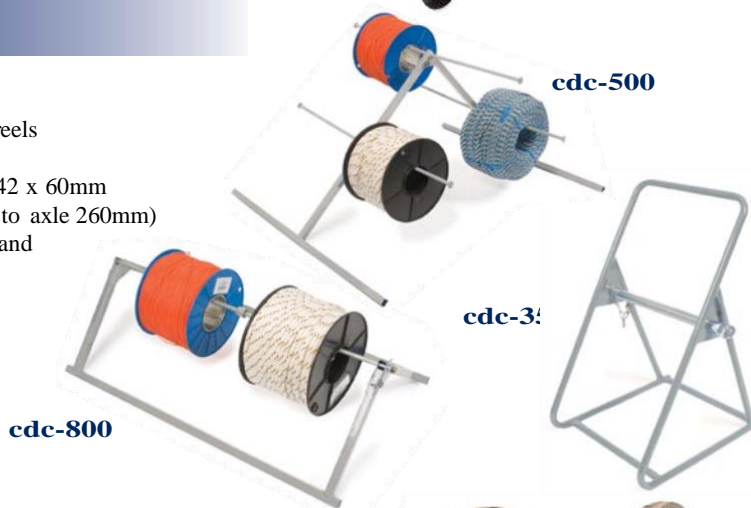

## Drum Rollers

<u>Code</u>	<u>Description</u>
DRR-800	S.W.L. 1.5 tonne Cable drum diameters Min 500mm – Max 1200mm

*DRR-800 Folded for storage and transport. Sold as pair.*



# Cable Laying aCCeSSORIEs

## Manhole Guards

Manufactured from aluminium for ease of handling. Standard models listed. Standard colour is safety yellow.

<u>Code</u>	<u>Description</u>
MGA-140RY	Manhole Guard with Roof (Yellow)
MGA-140Y	Manhole Guard No Roof (Yellow)

Other colours can be quoted on request.



**mga-140**  
140cm x 140cm  
Sold in pairs

<u>Code</u>	<u>Description</u>
MGA-070RY	Bi-fold Manhole Guard with Roof (Yellow)
MGA-070Y	Bi-fold Manhole Guard No Roof (Yellow)

Other colours can be quoted on request.

MGA-070 Folds down for station wagon or sedan boot.

**mga-070**  
140cm x 140cm  
each panel  
70cm wide  
Sold in pairs



## Manhole Pit Key

The standard pit key (MPK-500) is designed to lift Telstra style manhole lids and comes with a safety lock. The manhole lid breaker (MPKF-200) can be coupled onto it to open difficult and jammed manhole lids. Simply place the forks of the breaker under the key's side-fins and press down with your foot on the other end whilst pulling up with your arm. This lifts stubborn lids with ease and saves your back!

<u>Code</u>	<u>Description</u>
MPK-500	Manhole Pit Key
MPKF-200	Manhole Lid Breaker



**mpK-500**

**mpKf-200**

*Detail of MPK-500  
and MPKF-200  
coupled together*

## Long Handled Gatic Lifter

Suits heavy duty pit lids.

<u>Code</u>	<u>Description</u>
MPKF-01	Long Handle Manhole Lid Lifter



## Pillar Box Spanner

Spanner to suit 21mm x 26mm AF (1/2" x 5/8" BSW).

<u>Code</u>	<u>Description</u>
PBS-2126	Pillar Box Spanner



## Splicers Table

Size 1200mm x 500mm x 635mm. Weight 11 KGS. Table features fold-up legs that are adjustable legs for use on uneven ground.

<u>Code</u>	<u>Description</u>
QJI-125	Splicers Table - Folding Legs



## Cable Lubricant Selection Guide

### Aqualube A — Type ALA (Clear)

General purpose cable lubricant: Electrical contractors and utility linesmen will find 'Type A' excellent for all general cable hauling operations. Suitable for all cable including fibre optic and all conduits. It is a pourable liquid with a unique stringy flow.

<u>Code</u>	<u>Description</u>
ALA-01	1ltr Bottle (supplied in carton of 12)
ALA-20	20 ltr Drum
ALA-200	200 ltr Drum

### Aquagel — Type AQG (Green)

High Performance Lubricant Gel: Suitable for heavy power cable and roughly sheathed cable (eg. hessian, bitumen etc.). This is a thixotropic gel that enables hand application to the cable.

<u>Code</u>	<u>Description</u>
AQG-01	1ltr Bottle (supplied in carton of 12)
AQG-20	20 ltr Drum
AQG-200	200 ltr Drum

### Aqualube G — Type ALG (Blue)

Heavier grade cable lubricant: Effective for conduit pre-lubrication in concrete conduits, vertical pulls, old, rough or water-filled conduits. Excellently suited for large-sized cable during extra long distance pulls and hot weather environments.

<u>Code</u>	<u>Description</u>
ALG-01	1ltr Bottle (supplied in carton of 12)
ALG-20	20 ltr Drum
ALG-200	200 ltr Drum



*CLP Lube can be packaged to suit your needs. Please contact our sales staff for assistance.*

For Application Tools, view our Foam Carriers (DFCs) on page 10 or Short Rubber Slugs (SRS) on page 14.

All Aqualube and AquaGel products leave a harmless powder residue that remains indefinitely after evaporation and which, with the addition of water, allows the cable to be easily removed at a later date.



# UNDERGROUND Cable EQUIPMENT

## Electric Blowers

Featuring 2 motors and delivering 7 cubic metres of air at a safe low pressure, this unit will effectively blow a lightweight drawline up to 1000 metres of lubricated unoccupied conduit.

Each motor will deliver approximately 3.5 cubic metres of air per minute. This low pressure system has been designed for rough external work suited to long PVC duct runs with many bends.

This one man operation is a quick and safe method of roping conduit.

- 2 x 240v motors, 1100 watts each - 2200 watts total power
- Weatherproof switches
- Separate fan from the motor for longer motor life
- Rubber feet to insulate unit from the ground
- Camloc fittings on hose pipe

Code	Description
DBI-02K	2 Stage Electric Duct Blower kit comprising the following parts:
1 x DBI-02	2 Stage Electric Blower
1 x DAH-506	5m hose assembly with fittings
1 x DAH-030	Conduit Sealer 32-63mm
1 x DAH-040	Conduit Sealer 63-150mm
1 x CKC-800	Galvanised kit box



## Individual Components

Code	Description
DBI-02	2 Stage Electric Blower
DAH-050	50mm Air Hose 5m
DAH-060	Seal-Off Body
DAH-080M	Male Coupling
DAH-080F	Female Coupling
DAH-020	Conduit Sealer 13 - 25mm
DAH-030	Conduit Sealer 32 - 63mm
DAH-040	Conduit Sealer 63 - 150mm
DAH-506	5m hose assembly with fittings

## Drawline Pressure Roping Gun and Seal-off Kit

For hands free operation. Suitable for conduits ranging from 50mm to 150mm and roping grommets to accommodate rope from 4mm to 12mm.

Code	Description
DPL-400	Pressure Roper Gun
DPL-350	Adaptor for DAH Seal-Off*
DPL-600	Tool box
DPL-050	50mm Conduit Seal-Off
DPL-080	80mm Conduit Seal Off
DPL-100	100mm Conduit Seal-Off
DPL-125	125mm Conduit Seal Off
DPL-150	150mm Conduit Seal-Off
DRG-04	4mm Grommet
DRG-06	6mm Grommet
DRG-08	8mm Grommet
DRG-10	10mm Grommet
DRG-12	12mm Grommet
DPL-500	Complete Kit**



\* Not hands free.

\*\*Kit comprises: 1 Gun, 5 Seals, 5 Grommets, Tool box.

# UNDERGROUND Cable EQUIPMENT

## Occupied Conduit Adaptor

Operates similarly to DPL-400; adaptor fits straight into the conduit. Designed for 80-100mm conduit.

<u>Code</u>	<u>Description</u>
OCA-100	Occupied conduit adaptor



## Poly Drawline

Manufactured from natural polypropylene in light and heavy gauge.

<u>Code</u>	<u>Description</u>
DL-31000	3mm x 1000m Orange, very tough & compact drawline
DL-4850	4mm x 850m Blue heavy gauge Poly Drawline
DL-6500	6mm x 500m Blue Yellow "Parramatta Rope"



## Spectra Rope

Is constructed with internal Spectra filaments encased inside a polyester braid. Lengths cut to your requirements.

<u>Code</u>	<u>Description</u>
DL-02	2mm dia - 2.45kN U.T.S.
DL-03	3mm dia - 3.92kN U.T.S.
DL-04	4mm dia - 8.82kN U.T.S.
DL-05	5mm dia - 10.78kN U.T.S.
DL-06	6mm dia - 16.67kN U.T.S.
DL-08	8mm dia - 32.36kN U.T.S.
DL-10	10mm dia - 48.05kN U.T.S.
DL-12	12mm dia - 56.87kN U.T.S.
DL-14	14mm dia - 65.70kN U.T.S.



**special service**  
Eyes can be spliced upon request

**can't see the rope you require?  
call us, we are here to help.  
phone: 07 3276 7166 or email: sales@cablelaying.com.au**

## Wire Cable Bridles

From 2 to 4 slings in staggered lengths with clevis ends. These are fitted to a single hauling ring for multiple cable or subduct hauling.

<u>Code</u>	<u>No. of Slings</u>	<u>Wire Dia.</u>	<u>Max. SWL</u>
WCB-702	2	5mm (gal.)	1500kg
WCB-703	3	5mm (gal.)	1500kg
WCB-704	4	5mm (gal.)	1500kg



# UNDERGROUND Cable EQUIPMENT

## Balloon Line Carriers

Shaped like a balloon, with a rigid plastic mouth to ensure the balloon stays inflated.

<u>Code</u>	<u>Description</u>
DBL-050	Suits 50mm Conduit
DBL-080	Suits 80mm Conduit
DBL-100	Suits 100mm Conduit
DBL-125	Suits 125mm Conduit
DBL-150	Suits 150mm Conduit
DBL-225	Suits 225mm Conduit



## Bag Line Carriers

<u>Code</u>	<u>Description</u>
DCB-035	Suits 35mm Conduit
DCB-050	Suits 50mm Conduit
DCB-080	Suits 80mm Conduit
DCB-100	Suits 100mm Conduit
DCB-125	Suits 125mm Conduit
DCB-150	Suits 150mm Conduit
DCB-225	Suits 225mm Conduit



## Foam Line Carriers

For short runs in small to medium size conduits or to pre-lubricate the conduit.

<u>Code</u>	<u>Description</u>
DFC-020	Suits 20mm Conduit
DFC-030	Suits 30mm Conduit
DFC-040	Suits 40mm Conduit
DFC-050	Suits 50mm Conduit
DFC-080	Suits 80mm Conduit
DFC-100	Suits 100mm Conduit
DFC-125	Suits 125mm Conduit



## Plastic Cone Shaped Line Carriers

For blowing at high speed through long distances of unoccupied conduit. The carrier will operate in out of round duct or over minor obstructions.

<u>Code</u>	<u>Description</u>
DCC-050	Suits 50mm Conduit
DCC-100	Suits 100mm Conduit
DCC-125	Suits 125mm Conduit
DCC-150	Suits 150mm Conduit



# SCREW-ON HAULING EYES

## Screw-On Power Cable Hauling Eye

CLP's screw-on power cable hauling eye is designed to offer maximum gripping strength on cable conductors of all types and sizes and suits all cable with an inner core. A short extension sleeve covers and protects the face of the cable insulation during hauling.

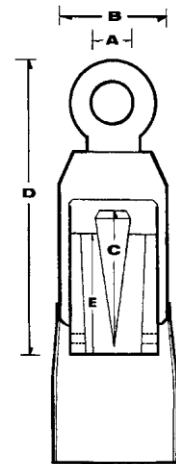

Code	Conductor Dia	Inside Dia of Eye A	Outside Dia of Head B	Length Spike C	Length of Head D	Length of Nut E
CER-2025	20-25	24	60	70	95	50
CER-2530	25-30	24	60	70	95	50
CER-3035	30-35	24	70	82	125	80
CER-3540	35-40	29	70	100	125	80
CER-4045	40-45	29	82	116	190	90
CER-4550	45-50	29	89	116	215	95
CER-5055	50-55	29	100	135	215	95
Tolerance	± 1	± 2	± 3	± 3	± 1	

## Procedures for Installing the Screw-On Power Eye

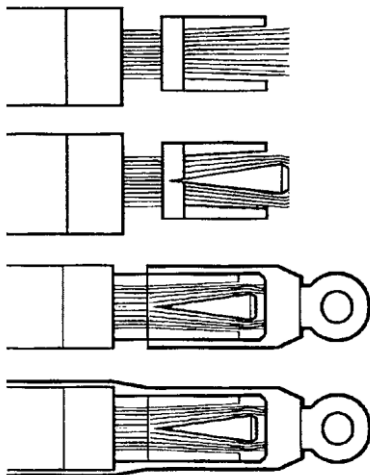

1. Remove all insulation materials, including the sheathing on the sectors inside, for a length 40mm longer than the nut used. Slide the nut over the exposed conductors securing it about 20mm in front of the sheathing stack, with the grub screws in the rear shoulder of the nut.
2. Hammer the conical shaped pin into the mass of wires until it won't move any further. If the top of the pin is below the lip of the nut by more than 20mm then a larger pin should be used. (The pin will protrude past the end of the nut, this is normal.)
3. Screw the head onto the nut and secure it with the grub screws situated at the bottom of the head.
4. If the head has a sleeve attached, then this should be crimped down onto the outer sheath of the cable to seal the cable from water and dirt, or covered with a piece of heat shrink tubing.

## Screw-On Fibre Optic Cable Hauling Eye

Fibre optic hauling eyes designed for securing the cable in one simple operation without affecting the fibres. No special tools are required, making these eyes easy to use in the field.



Code	Description
FOH-1965	19mm OD Head 6.5mm ID
FOC-25	Sleeve to suit CTM of 2.5mm
FOC-30	Sleeve to suit CTM of 3.0mm
FOC-35	Sleeve to suit CTM of 3.5mm
FOC-40	Sleeve to suit CTM of 4.0mm
FOS-12	Skirt to suit 8-11mm OD cable
FOS-18	Skirt to suit 11-17mm OD cable
FOS-23	Skirt to suit 17-22mm OD cable
FOG-00	Super gel adhesive
FOP-00	Punch for removing FOC

Code	Description
FOH-KIT	Reusable CS fibre eye pulling kit

### Kit comprises

1 x FPB-100 Plastic box	1 x FOS-23 Skirt to suit 17-22mm OD cable
1 x FOG-00 Super gel Adhesive	3 x FOC-25 Sleeve to suit CTM of 2.5mm
1 x FOP-00 Punch	3 x FOC-30 Sleeve to suit CTM of 3.0mm
1 x FOS-12 Skirt to suit 8-11mm OD cable	1 x FOH-1965 19mm Head
1 x FOS-18 Skirt to suit 11-17mm OD cable	2 x Allen keys to suit

# CONDUIT & ManHOIE Cable GUIDES

## Manhole Guides

<u>Code</u>	<u>Description</u>
MPSG-05C	Pivoting cable slipper for cable up to 50mm dia.
MPSG-10C	Pivoting cable slipper for cable up to 100mm dia.

<u>Code</u>	<u>Description</u>
MPRG-080	Pivoting Cable Bend with rollers for cable up to 80mm dia.
MPRG-140	Pivoting Cable Bend with rollers for cable up to 140mm dia.

<u>Code</u>	<u>Description</u>
MRG-140	Single Roller Guide for cable up to 140mm dia.

<u>Code</u>	<u>Description</u>
MTRG-140	Twin Roller Guide for cable up to 140mm dia.

<u>Code</u>	<u>Description</u>
MTRGH-140	Twin Roller Guide with hangers for supporting upside down on the edge of manhole.



## Split Lock Roller Guide

<u>Code</u>	<u>Description</u>	<u>Unit Diameter</u>
SRG-044	Single Roller	44mm dia.
SRG-080	Single Roller	80mm dia.
SRG-095	Single Roller	95mm dia.
SRG-115	Single Roller	115mm dia.
SRG-140	Single Roller	140mm dia.
SRG-095-Q	Quad Roller	95mm dia.
SRG-115-Q	Quad Roller	115mm dia.



*Quad Roller*

## Aluminium Cable Guide

For use with non-abrasive ropes (not galvanised or metal), to pull fibre optic cable. Suitable for 90mm conduit.

<u>Code</u>	<u>Description</u>
ACG-100	Aluminium Cable Guide



## Cable Guiding Bends / Slippers

<u>Code</u>	<u>Unit Diameter</u>
CCG-029	29mm dia.
CCG-033	33mm dia.
CCG-045	45mm dia.
CCG-080	80mm dia.
CCG-097	97mm dia.
CCG-115	115mm dia.
CCG-140	140mm dia.



# CONDUIT & ManHOIE Cable GUIDES

## Hinged Cable Guide Bends / Slippers

<u>Code</u>	<u>Unit Diameter</u>
SCG-044	44mm dia.
SCG-080	80mm dia.
SCG-095	95mm dia.
SCG-115	115mm dia.
SCG-140	140mm dia.



## Corner Rollers for Trenches

Suitable for loads up to 500kgs.  
Supplied as single units. Stakes sold separately.

<u>Code</u>	<u>Description</u>
TCR-200	Trench Corner Roller
STK-400	400mm Long Pit Stake
STK-600	600mm Long Pit Stake
STK-1200	1200mm Long Pit Stake



stK-400

## Trench Rollers

Suitable for loads up to 500kgs.

<u>Code</u>	<u>Description</u>
TSR-140	Raised Trench Roller Guide for occupied trenches Suits cable up to 140mm dia.

<u>Code</u>	<u>Description</u>
FSR-140	Flat Trench Roller Guide Suits cable up to 140mm dia.



## Replacement Rollers for Underground and Aerial Construction Equipment

Fitted with sealed ball bearings.

<u>Code</u>	<u>Description</u>
ALR-050	Suits 50mm diameter cable
ALR-080	Suits 80mm diameter cable
ALR-100	Suits 100mm diameter cable
ALR-140	Suits 140mm diameter cable



(mm)	A	B	ØC	Pin ØD	E
ALR-050	75	65	21	10.0	61
ALR-080	104	91	30	12.0	81
ALR-100	124	115	40	16.0	100
ALR-140	165	155	51	16.0	120

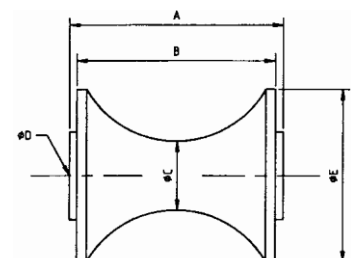

# MaNDREls & swIVeIs

## Conduit Cleaner

Suitable for cleaning conduit of sand, mud and other debris.

<u>Code</u>	<u>Description</u>	<u>Unit Diameter</u>
RCC-048	Rubber Conduit Cleaner	48mm dia.
RCC-078	Rubber Conduit Cleaner	78mm dia.
RCC-098	Rubber Conduit Cleaner	98mm dia.
RCC-123	Rubber Conduit Cleaner	123mm dia.
RCC-148	Rubber Conduit Cleaner	148mm dia.



## Short Rubber Slug

Suitable for proving duct integrity, cleaning sand, mud and spreading lubricant, especially on tight radius bends.

<u>Code</u>	<u>Description</u>	<u>Unit Diameter</u>
SRS-048	Short Rubber Slug	48mm dia.
SRS-078	Short Rubber Slug	78mm dia.
SRS-098	Short Rubber Slug	98mm dia.
SRS-123	Short Rubber Slug	123mm dia.
SRS-148	Short Rubber Slug	148mm dia.



## Proving Mandrel

Suitable for proving or testing duct integrity.

<u>Code</u>	<u>Description</u>	<u>Unit Diameter</u>	<u>Code</u>	<u>Description</u>	<u>Unit Diameter</u>
PMN-014	Test Mandrel	14mm dia.	PMN-096	Test Mandrel	96mm dia.
PMN-018	Test Mandrel	18mm dia.	PMN-118	Test Mandrel	118mm dia.
PMN-028	Test Mandrel	28mm dia.	PMN-121	Test Mandrel	121mm dia.
PMN-048	Test Mandrel	48mm dia.	PMN-138	Test Mandrel	138mm dia.
PMN-078	Test Mandrel	78mm dia.	PMN-146	Test Mandrel	146mm dia.
PMN-088	Test Mandrel	88mm dia.		Special sizes can be quoted on request.	



## High Pressure Drawline Carrier

Only for use with compressed air in long runs or water-filled conduit. Ideally suited for pushing water ahead of itself.

<u>Code</u>	<u>Description</u>	<u>Unit Diameter</u>
PDC-048	High Pressure Drawline Carrier	48mm dia.
PDC-078	High Pressure Drawline Carrier	78mm dia.
PDC-098	High Pressure Drawline Carrier	98mm dia.
PDC-123	High Pressure Drawline Carrier	123mm dia.
PDC-148	High Pressure Drawline Carrier	148mm dia.



## Wire Brush Mandrel

Steel bristles for cleaning conduit of sand, rocks, grit and other light obstructions.

<u>Code</u>	<u>Description</u>	<u>Unit Diameter</u>
WBM-050	Wire Brush Mandrel	50mm dia.
WBM-080	Wire Brush Mandrel	80mm dia.
WBM-100	Wire Brush Mandrel	100mm dia.
WBM-125	Wire Brush Mandrel	125mm dia.
WBM-150	Wire Brush Mandrel	150mm dia.



# MaNDREls & swIVeIs

## Swivels

### SWI Type (Clevis to Clevis)



### SWIRF Type

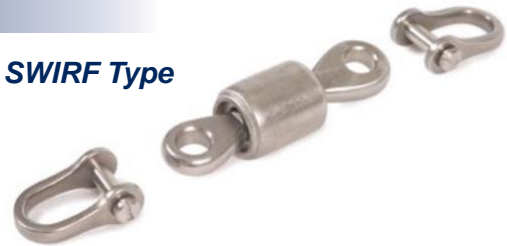

The swivels have been manufactured with sealed bearings and are precision machined from high grade steel. They have been NATA certified for a 3:1 safety factor.

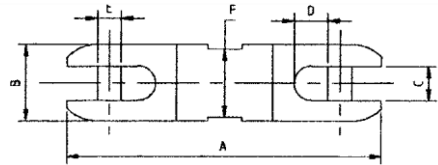

### SWI Type (Clevis to Clevis)

Code	A (mm)	ØB	C	D	ØE	F AF	Load
SWI-16	88.0	16.0	7.0	8.6	5.0	14.0	6kN
SWI-22	114.0	22.0	10.0	10.0	7.94	20.0	10kN
SWI-33	144.0	33.0	16.0	16.8	10.0	29.0	18kN
SWI-42	173.0	42.0	18.0	22.3	12.0	36.0	35kN
SWI-60	250.00	60.0	26.0	25.4	19.05	56.0	50kN

### SWIRF Type

Code	Description	Load
SWIRF-78	Swivel Eye to Eye	6kN
SWIRF-150	D Shackle to suit SWIRF-78	6kN

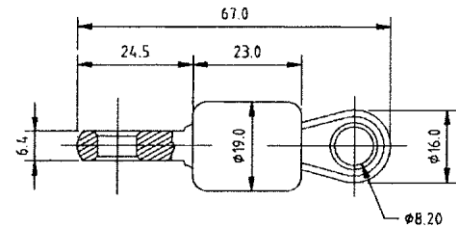

### Galvanised Heavy Duty Swivels

Code	D Ø mm	A mm	B mm	C mm	L mm
RWB320A	10	18	30	21	103
RWB320B	12	20	36	30	130
RWB320C	16	25	42	42	155
RWB320D	20	30	47	42	178
RWB320E	25	40	60	57	250

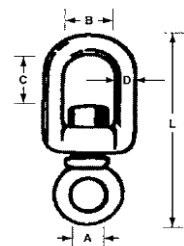

### Stainless Steel Swivels - Eye to Eye

Code	D Ø mm	A mm	L mm	B mm	C mm	Br/Str/Kg
56106	6	15	65	15	15	1350
56108	8	22	90	20	20	2500
56110	10	27	115	24	24	3500
56111	13	35	154	56	32	5000

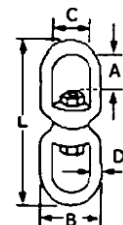

### D Shackles 316 S/S - CSK Slotted Head

Code	D Ø mm	L mm	B mm	A mm	Br/Str/Kg
56060	6	21	12	6	2000
56061	7	24	14	7	3000
56062	8	28	15	8	3600
56063	10	35	20	10	5500

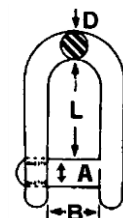



## Pole Bracket

<u>Code</u>	<u>Description</u>
RPB-100	Lightweight Ratchet Pole Bracket Ratchet Strap sold separately: RATSTRP-50



## Pole Bracket Adaptor

Used with RPB-100 the adaptor converts the vertical shaft of the pole bracket to a horizontal axis for fitting a cable guiding roller on a corner block

<u>Code</u>	<u>Description</u>
APH-207	Pole Bracket Adaptor



## Aerial Guide Chute

<u>Code</u>	<u>Description</u>
AGC-301	Guiding Chute



## 45° Corner Block

Provides a 500mm radius around an inside or outside corner at angles up to 45°. These blocks are mounted on the pole bracket RPB-100 and, with the use of the APH-207, can be utilised at a variety of angles. Standard rollers are acetal. Non standard roller profiles can be quoted on request.

<u>Code</u>	<u>Description</u>
ACB-0451	45° Corner Block for Single Cable
ACB-0452	45° Corner Block for Double Cable



## 90° Corner Block

Provides a 500mm radius for angles up to 90°. Application and roller specifications are the same as for the 45° blocks.

<u>Code</u>	<u>Description</u>
ACB-0901	90° Corner Block for Single Cable
ACB-0902	90° Corner Block for Double Cable



## Overhead Catenary Stringing Rollers

For use with Fibre or Coaxial cable up to 25mm in diameter.

<u>Code</u>	<u>Description</u>
ASR-040	Single Roller
ASR-080	Double Roller



## Double Overhead Roller

<u>Code</u>	<u>Description</u>
ADR-120	Double Overhead Roller



## Insulator Clamp Bracket

<u>Code</u>	<u>Description</u>
ICB-001	Clamps directly onto the insulator. Tension can be easily adjusted, allowing the unit to be turned 90°, thus dropping the cable onto the insulator.



## Cross Arm Bracket

Versatile and easy to use, it has a hinged top flap allowing quick entrapment of the cable.

<u>Code</u>	<u>Description</u>
CAB-002	80mm Roller
RATSTRP-35	Ratchet strap sold separately.



## Single Cable Blocks

Rollers are manufactured from aluminium.

<u>Code</u>	<u>Description</u>
ASB-050	Aerial Stringing Block, suits cable up to 50mm dia.
ASB-3100	Aluminium sheave, 150mm radius, 100mm rollers
ASB-6140	Aluminium sheave, 300mm radius, 140mm rollers
SCB-050	Single captive block, suits cable up to 50mm dia.
SCB-080	Single captive block, suits cable up to 80mm dia.
SCB-140	Single captive block, suits cable up to 140mm dia.



## Cable Tray Rollers

<u>Code</u>	<u>Description</u>
CTR-050	Cable Tray unit used to form a radius by bolting to individual rungs in the tray or used as multiple units. Roller suits cable up to 50mm dia.
CTR-080	Cable Tray unit with twin rollers, used where changes in a vertical direction are required. Roller suits cable up to 80mm dia.
CTR-140	Cable Tray roller suits cable up to 140mm dia.
CRG-165	Cable Roller Guide Roller suits cable up to 150mm dia. Removable top roller



# QUICK FLICK shelters

*Provide protection from adverse weather conditions in seconds*

CLP's QUICK FLICK Shelters, with their integral frame and skin, allow you to erect the shelter in seconds (similar to opening an umbrella) to provide a sheltered work area. The lightweight polyester fabric, selected for its resistance to mildew and ultraviolet rays, has been further treated for fire retardance and water resistance to Telstra specifications. Fibreglass rods, chosen for their strength and flexibility, are used on the frame which, if damaged, can be easily repaired.



**Qfs-180t**

## **Quick Flick Shelter**

For protection from the elements during splicing or working on a cabinet.

Includes:

- 3 screened windows with roll-up flaps
- Tie-down cords and roof strap
- Ground flaps for anchoring with sandbags
- Wide open front for easy access
- Quick release clips on front flaps to connect 2 tents together and double the working space
- Port hole in side wall for heater or cooler blower or to allow entry of cable or conduit when doing fusion or splicing in the tent
- Carry bag, ground sheet, 6 sand bags and 3 tent pegs

## **Quick Flick Trench Tent**

For protection from the elements during trenching.

Includes:

- Ground flaps for anchoring with sandbags
- Tie-down cords
- Wide open front and back for easy access and placement over trenches
- Quick release clips on front and rear flaps to connect multiple tents end to end and increase the working length
- Carry bag, 6 sand bags and 2 tent pegs



**Qftt-2525**



**Qms-150s**

## **Manhole Guard Cover**

For protection from the elements when working in manholes or pits.

Includes:

- Waterproof material
- Double stitching
- Tie-down straps and cords
- Zip access
- Viewing window
- Carry bag, ground sheet, 6 sand bags and 2 tent pegs

Code	Dimensions (Metres)	Description	Supplied with
QFS-180T	1.8 x 1.8 x 1.8	Shelter, twin capability	Carry bag, 6x sand bags, ground sheet, 3x guy ropes & pegs
QFTT-2525	2.4 x 2.5 x 2.0	"A" Frame Trench Tent	Carry bag, 6x sand bags, 2x guy ropes & pegs
QMS-150S	1.4 x 1.4 x 1.2	Manhole guard cover	Carry bag

# WIRE Cable GRIPS

CLP manufactures a range of hand woven wire cable grips that is designed for hauling power, telecommunication, data, fibre optic and coaxial cables and for winching rope through conduits, trenches and overhead poles. High quality galvanized steel wire is used in weaving the individual grips – **stainless steel is available on request\***. The weaving process leaves no loose or frayed wires at the tail end to cause damage to the cable or the conduit. The length of grips can be customised for customer's individual requirements.

Ferrules are swaged in our factory using a 150 tonne hydraulic press to ensure maximum strength and durability. Factors such as the diameter of the grip, the tension caused through hauling, the number of times the grip has been used and the attachments to the winching rope, all contribute towards the user deciding the effective safety and longevity of the grip. The user should be aware of stress, misuse and wear and tear which affect the safe working load of the grips and effect a change sooner rather than later. **these grips are designed to haul single cables.** A device such as the Wire Cable Bridle on page 9 should be used to haul multiple cables at one time. A safety factor of 3 has been applied to achieve the safe working load listed in the selection charts. \*Add the suffix 'SS' to the code to denote stainless steel; eg. LCG-0612DSS.

**following are the standard types of grips and their cable applications:**

**Closed Tubular Single Eye Code: TCG**

For light to medium hauling of communication and power cable. To be used in underground conduits, trenches, cable trays and for service lines to factories.

**Open Tubular Double Eye Code: DCG**

Ideally suited for the mining industry where cable needs to be laid and secured to the walls of shafts and tunnels. N.B. The effective strength of the grip is halved when hauling with only one eye.

**Open Tubular Offset Eye Code: OCG**

Used for pulling slack during final placement of cable in exchange buildings and at termination points such as pole tops where the end of the cable cannot be used to haul from.

**Lace-up Double Eye Code: LCG**

Generally used for supporting electricity cable in a vertical or sloping position and is also ideal for use in manholes where the longitudinal movement of the cable caused by road vibration needs to be checked.

Product Code	Suit Cable OD mm	Grip Length mm	Maximum Tensile Load KGs
LCG-0612D	6-12mm	300	992
LCG-0916D	9-16mm	350	1360
LCG-1422D	14-22mm	400	2040
LCG-2032D	20-32mm	500	2540
LCG-3240D	32-40mm	850	3048
LCG-4055D	40-55mm	900	4572
LCG-5575D	55-75mm	900	6240
LCG-7595D	75-95mm	900	9360
LCG-95114D	95-114mm	1000	12480
LCG-114126D	114-126mm	1100	19230
OCG-0612	6-12mm	300	992
OCG-0916	9-16mm	350	1360
OCG-1422	14-22mm	400	2040
OCG-2032	20-32mm	500	2540
OCG-3240	32-40mm	850	3048
OCG-4055	40-55mm	900	4572
OCG-5575	55-75mm	900	6240
OCG-7595	75-95mm	900	9360
OCG-95114	95-114mm	1000	12480
OCG-114126	114-126mm	1100	19230
TCG-0612	6-12mm	300	992
TCG-0916	9-16mm	400	1360
TCG-1422	14-22mm	450	2040
TCG-2032	20-32mm	550	2540
TCG-3240	32-40mm	700	3048
TCG-4055	40-55mm	850	4572
TCG-5575	55-75mm	950	6240
TCG-7595	75-95mm	1000	9360
TCG-95114	95-114mm	1200	12480
TCG-114126	114-126mm	1300	19230
DCG-0612	6-12mm	300	992
DCG-0916	9-16mm	350	1360
DCG-1422	14-22mm	400	2040
DCG-2032	20-32mm	500	2540
DCG-3240	32-40mm	850	3048
DCG-4055	40-55mm	900	4572
DCG-5575	55-75mm	900	6240
DCG-7595	75-95mm	900	9360
DCG-95114	95-114mm	1000	12480
DCG-114126	114-126mm	1100	19230



**do NOT use clp wire cable grips for lifting**

# Cable WINChING & JETTING EQUIPMENT

## Rolly Winch – ULP & Diesel

The Rolly Winch™ is the result of extensive research with our telecommunication and power cable customers. It is a heavy duty draw line pulling winch with a powerful Honda ULP or diesel engine able to handle the most demanding line hauling jobs.

### ULP

- m 4HP, 4 stroke petrol engine
- m 25:1 ratio gear box
- m 2 metre emergency stop switch
- m Capstan protector guard
- m Tow ball attachment
- m Continuous 1.8kN line pull
- m Maximum 3.5kN line pull

### Diesel

- m 4.8HP, 4 stroke diesel engine
- m 21:1 ratio gear box
- m 2 metre emergency stop switch
- m Capstan protector guard
- m Tow ball attachment
- m Continuous 1.8kN line pull
- m Maximum 3.5kN line pull



Code	Description
Rolly Winch™	Rolly Winch™, 1.8kN

**CLP is the Australia, New Zealand and South Pacific agent for Plumettaz cable jetting machines and winches. We offer a variety of jetting systems to meet your requirements.**

**Plumett has developed a wide range of jetting machines for underground and overhead blowing of fibre optical cable. New additions to the range over 2008, such as the MiniJet, UltimaZ and Lubricator, compliment an already extensive range.**

**Please call CLP on (07) 3276 7166, for an introduction to this exciting range of Swiss made machines.**



Founded in 1923, Plumettaz is a Swiss based company recognized around the world for its expertise in cable laying equipment for the energy & telecommunication industries. Its products are used in more than 60 countries throughout the world. [www.plumettaz.com](http://www.plumettaz.com)

### MiniJet

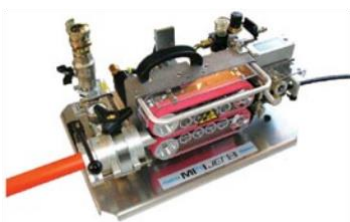

- m Easy installation and quick release of the cable, no tools required
- m No maintenance
- m Quick change of the belt
- m No vertical adjustment of the driving device (concentric belt drive) as the cable follows the same axis
- m Possible to achieve long distances
- m Bi-directional

### CableJet



- m Designed for blowing or floating telecommunication cables (mainly optical fibre, but also small coaxial and multipair cables) in preinstalled ducts
- m Can also be used as an intermediate assist for cascading
- m Possible to achieve long distances
- m Possible to remove old and place new cables in one step
- m Mono-directional

### SuperJet H



- m Designed for floating or blowing telecommunication and data transmission cables (mainly optical fibre, but also small coaxial and multipair cables) in preinstalled ducts
- m Can also be used as an intermediate assist for cascading
- m Possible to achieve long distances
- m Possible to remove cables
- m Mono-directional
- m Suitable for the bundle jetting kit

Type	Pushing Force (N)	Max Speed (m/min)	Rec. speed (m/min)	Dia. of cable (mm)	Outer dia. of duct (mm)	Max pressure (bar)	Dim. (mm)	Weight (kg)
MiniJet	300	100	60	4 – 16	8 – 40	16	520 x 375 x 380	20
CableJet	300	80	60	9 – 18	20 – 63	12	520 x 320 x 230	21
SuperJet H	700	60	40	14 – 40	20 – 63	12	915 x 260 x 410	37

# Cable WINChING & JETTING EQUIPMENT

## MicroJet PR-140

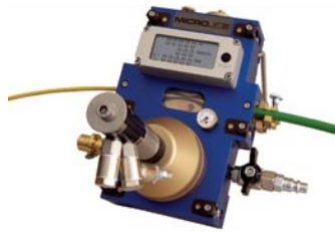

- m Designed for blowing or floating telecommunication and data transmission microcables (optical fibre, coaxial or multipair) in preinstalled ducts
- m Can also be used as an intermediate assist for cascading
- m Possible to achieve more than 2000m depending on the quality of micro duct route and material, and properties of micro cable
- m Possible to remove old and place new microcables, in one step
- m Bi-directional

## ServoJet



- m Designed for the installation of any kind of telecommunication and data transmission microcables with diameter 0.8 to 6 mm into pre-installed microducts
- m Operates as a jetting, pushing or pulling machine
- m Is fitted with a buckle detector giving optimal protection when installing fragile microcables

## UltimaZ



- m Designed for jetting, pushing/pulling indoor and outdoor FTTH drop micro-cables. It is powered by most types of existing electrical drills and screw drivers with an output torque exceeding 0.3 Nm at 250-500 RPM
- m Light and compact design
- m Ease of use, therefore high daily production and manpower saving
- m Little compressed air consumption, possibility of using compressed air bottles
- m Safety for both personnel and cable
- m To ensure a constant daily production capacity

Type	Pushing Force (N)	Max Speed (m/min)	Rec. speed (m/min)	Diam. of cable(mm)	Outer dia. of duct (mm)	Max pressure (bar)	Dim. (mm)	Weight (kg)
MicroJet PR-140	150	120	50	3.5 – 8	7 – 12	16	260 x 250 x 270	6
ServoJet	60			0.8 – 6	3 – 14			
UltimaZ V20	20*	40	50	0.8 – 4	3 – 12.7	12	188 x 101 x 148	1.7
UltimaZ F	**	40	50	0.8 – 4	3 – 12.7	12	193 x 101 x 159	1.4

\* Is equipped with an adjustable torque limiter and with a limiter locking device enables high pushing forces

\*\* Is equipped with a torque limiter with fixed setting providing a maximum pushing force ranging between 1 and 15 N in accordance with the customer request. for example: UltimaZ F5.0: pushing force of 5 N / UltimaZ F7.5: pushing force of 7.5 N

## Lubricator



- m Designed for the continuous lubrication of microcables in order to enhance longer installation distances at higher installation speed
- m Can be used in conjunction with most PLUMETT jetting equipment like ServoJet, MicroJet, MiniJet and CableJet
- m Can be used with microducts ranging from 4 to 16 mm outer diameter and micro-cables up to 8 mm diameter

## Y Connector



- m Used to install an additional cable in an already occupied duct.
- m Performance obtained corresponds to at least 50% that achieved with the first cable
- m One branch of the Y-connector, connected to the CableJet/ SuperJet, is used for feeding the second cable in the duct
- m Can also be used for the simultaneous installation of 2 cables using 2 machines
- m Installation distance achieved with 2 additional cables is nearly the same as that obtained with 1 cable

## Figaro / Figarino



- m Useful accessories to the "Jetting" system, particularly when the total drum length to be installed exceeds the installation capacity of the available "Jetting" unit(s)
- m Easy portability
- m Set-up by two persons
- m One person operation
- m Due to the open storage basket the Figarino can also be used as an "end storage device" where overlength cable can be stored directly into the Figarino at the end of the duct route; after **turning over the stored cable** the installation can be continued in the same direction